

29-02-001 , Engine Control 2,0 I 8V/16V EFI (Manual Transmission) , Ignition before 03/96

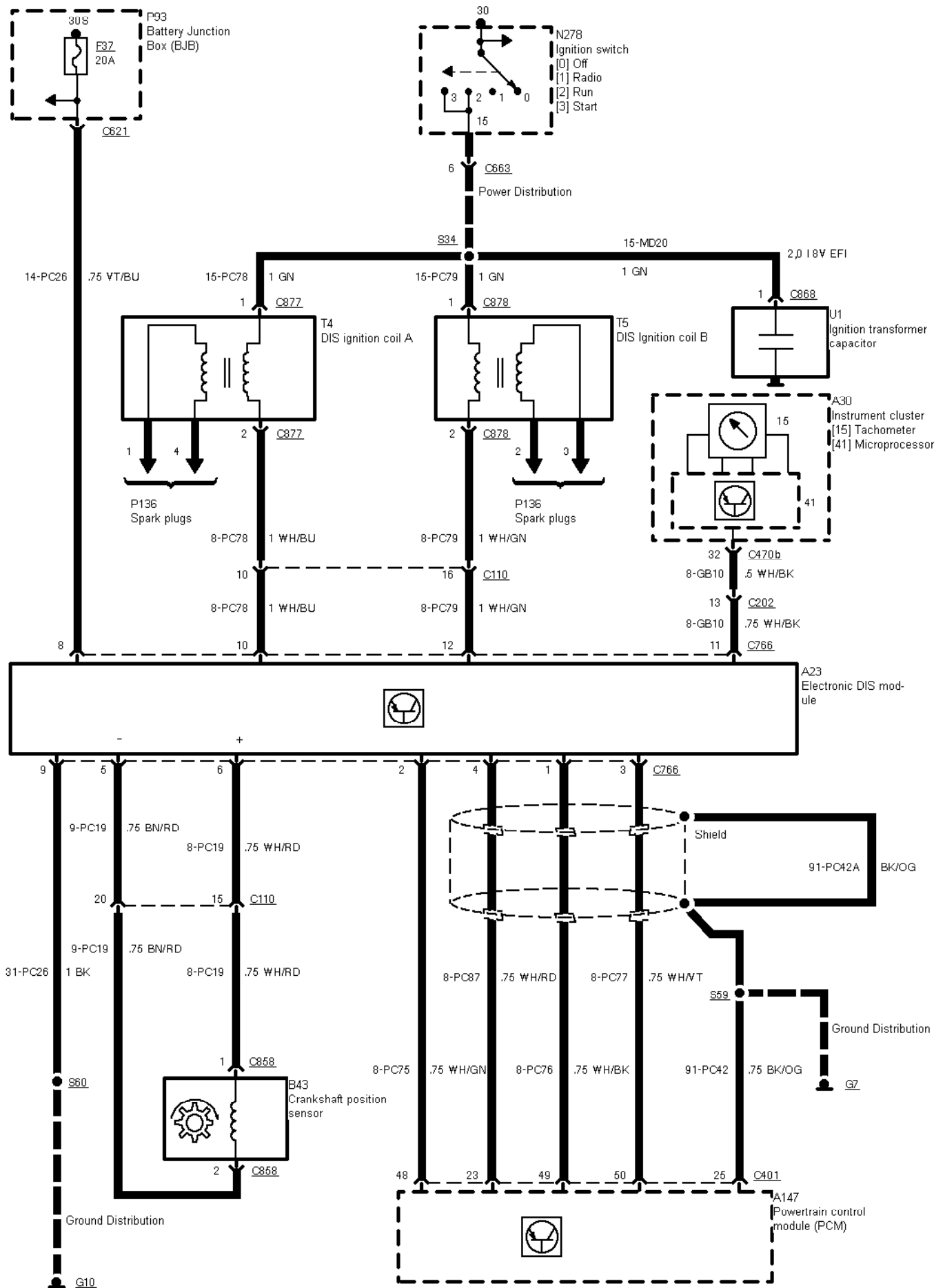

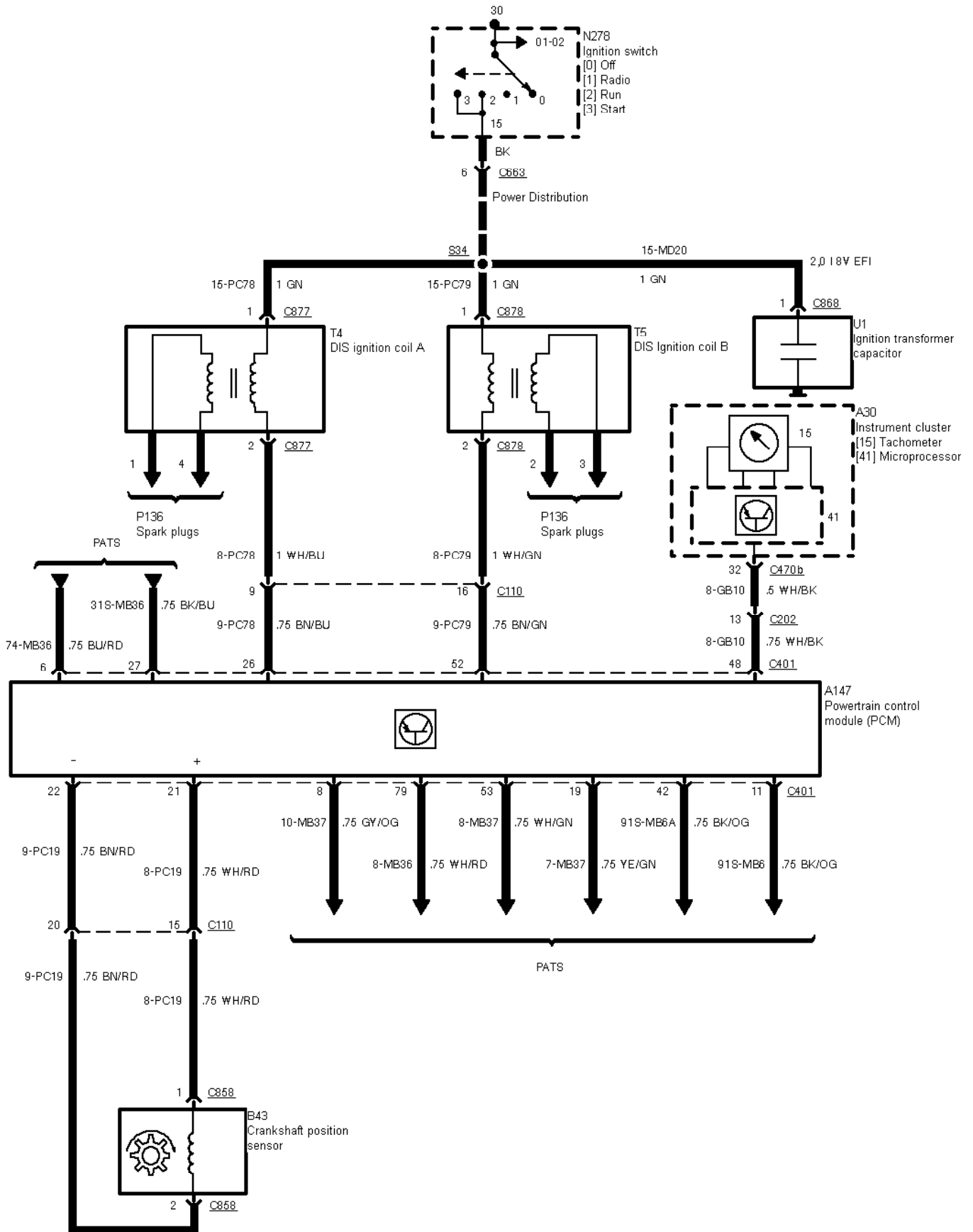

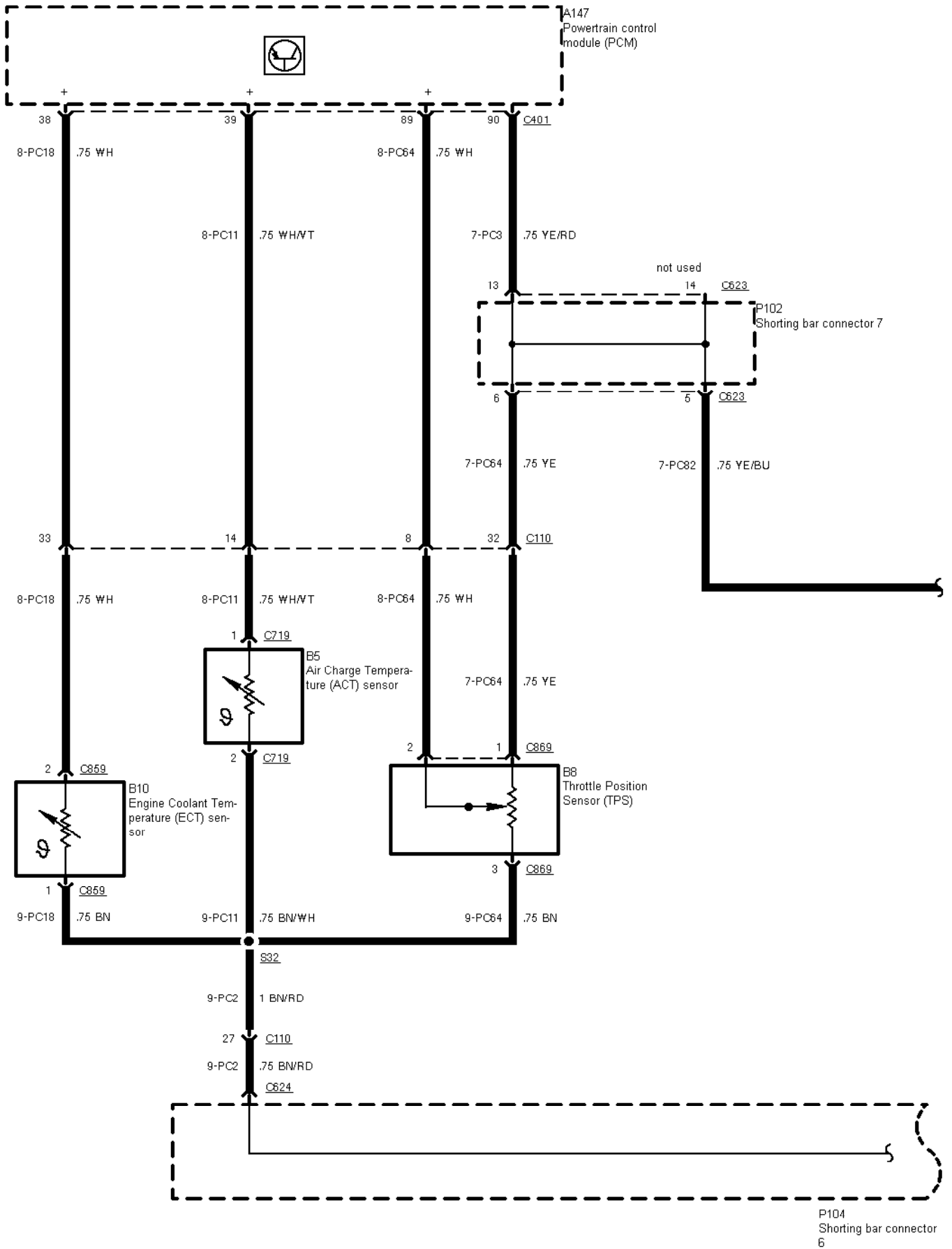

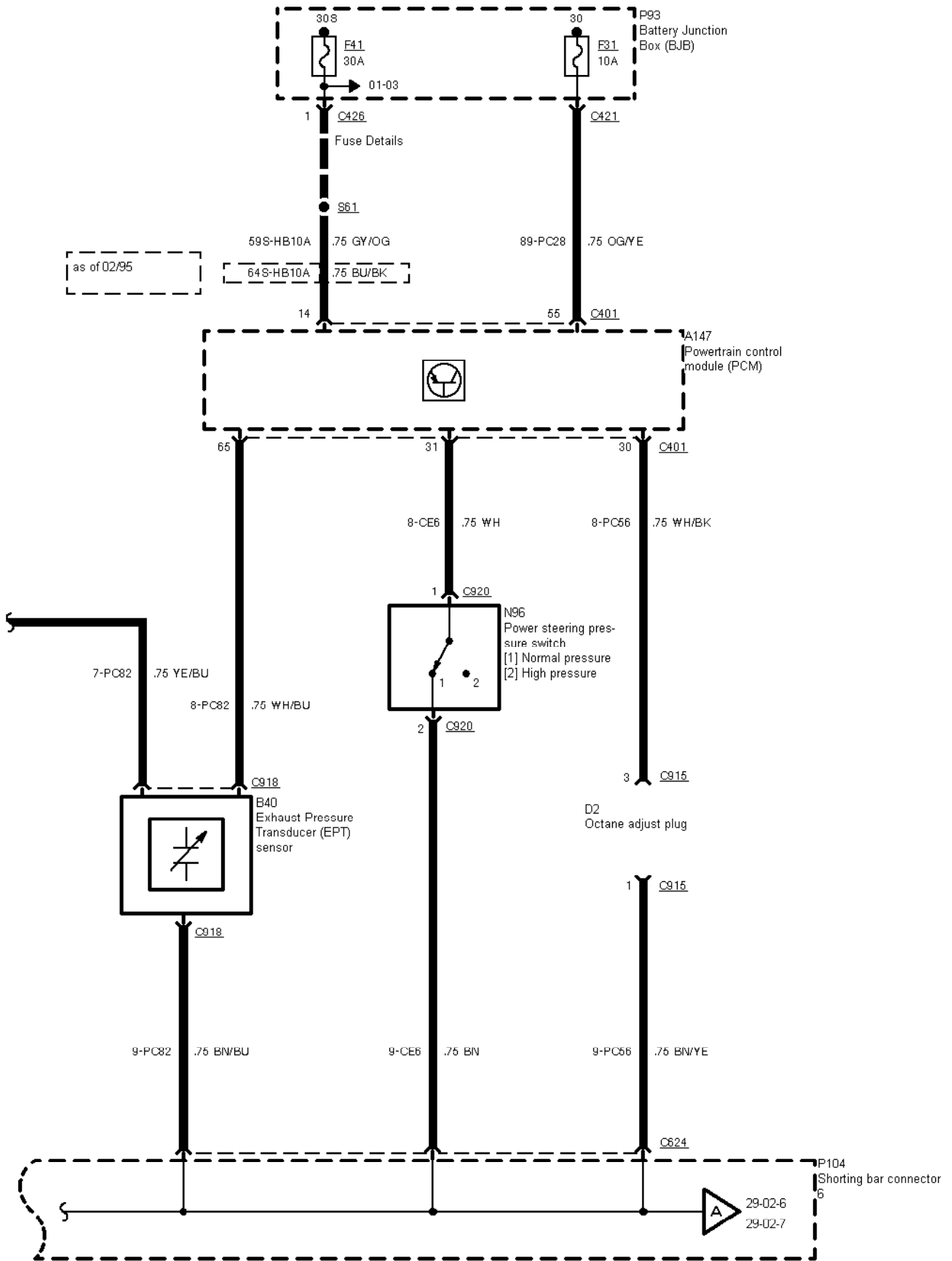

29-02-005 , Engine Control 2,0 I 8V/16V EFI (Manual Transmission) , Fuel injection

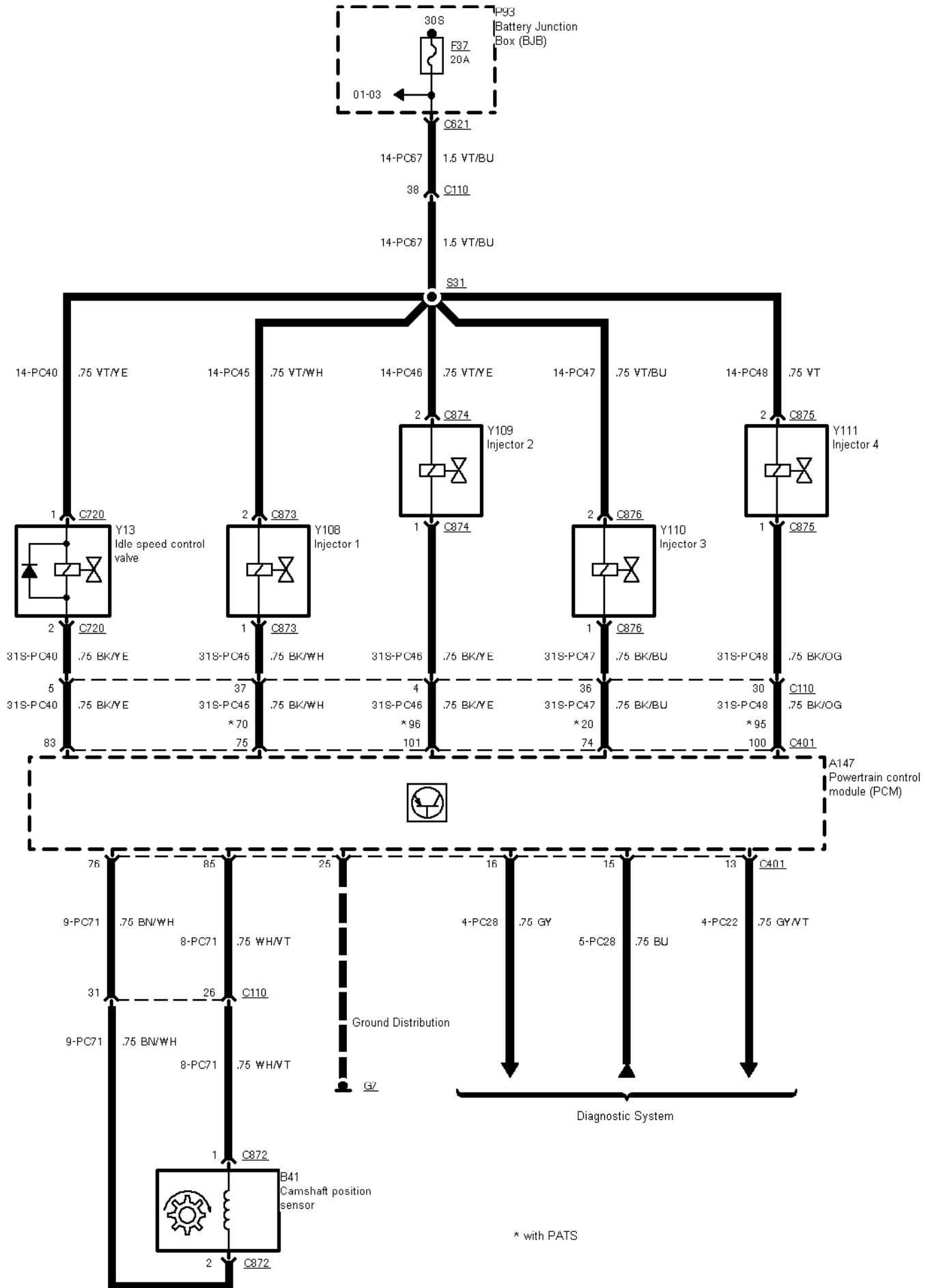

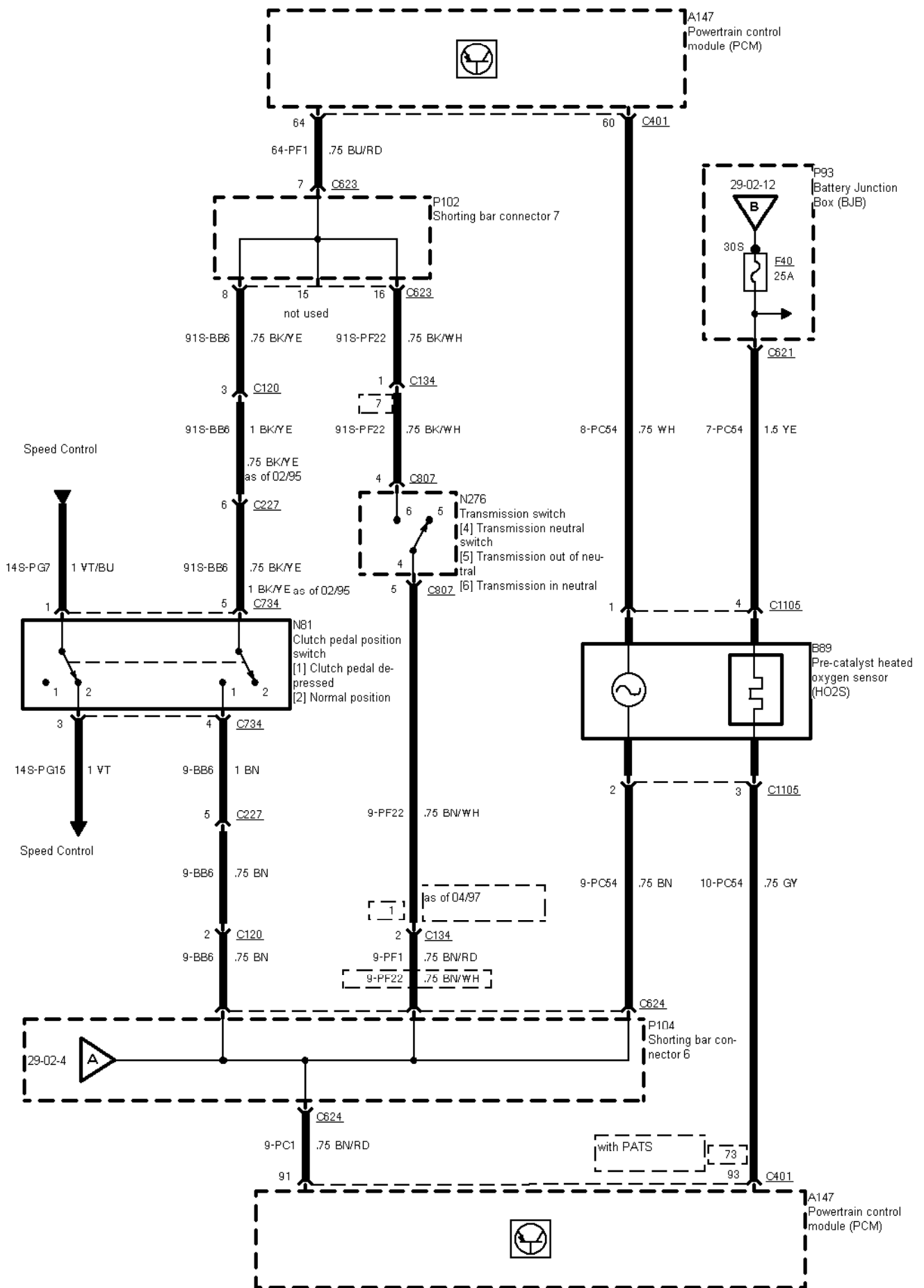

29-02-007 , Engine Control 2,0 I 8V/16V EFI (Manual Transmission) , 2,0 I 16V EFI, 2,0 I 8V EFI before 02/95, 2,0 I 8V EFI from 03/96 to 04/97

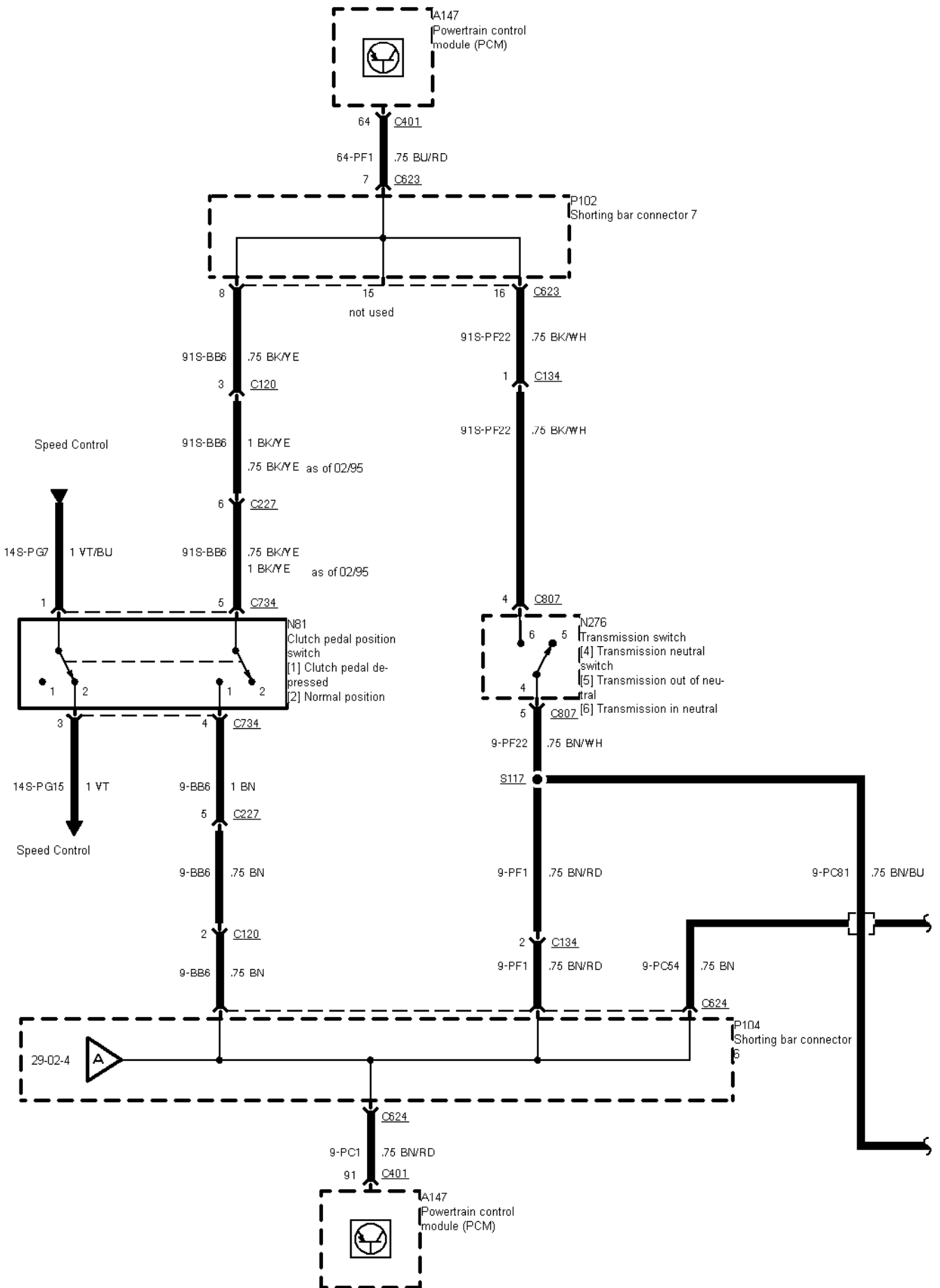

29-02-008 , Engine Control 2,0 I 8V/16V EFI (Manual Transmission) , 2,0 I 16V EFI, 2,0 I 8V EFI before 02/95,
 2,0 I 8V EFI from 03/96 to 04/97 Sensors

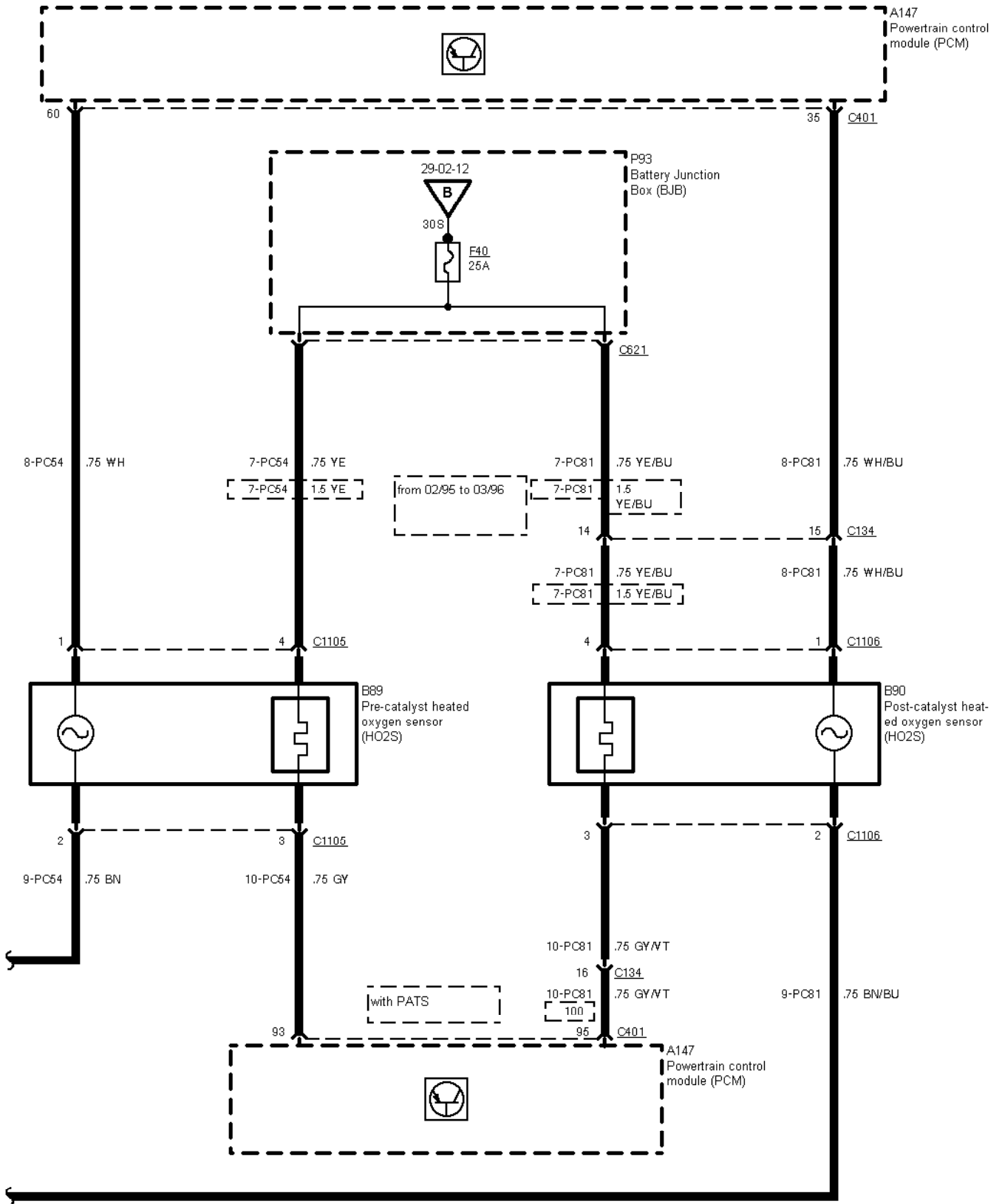

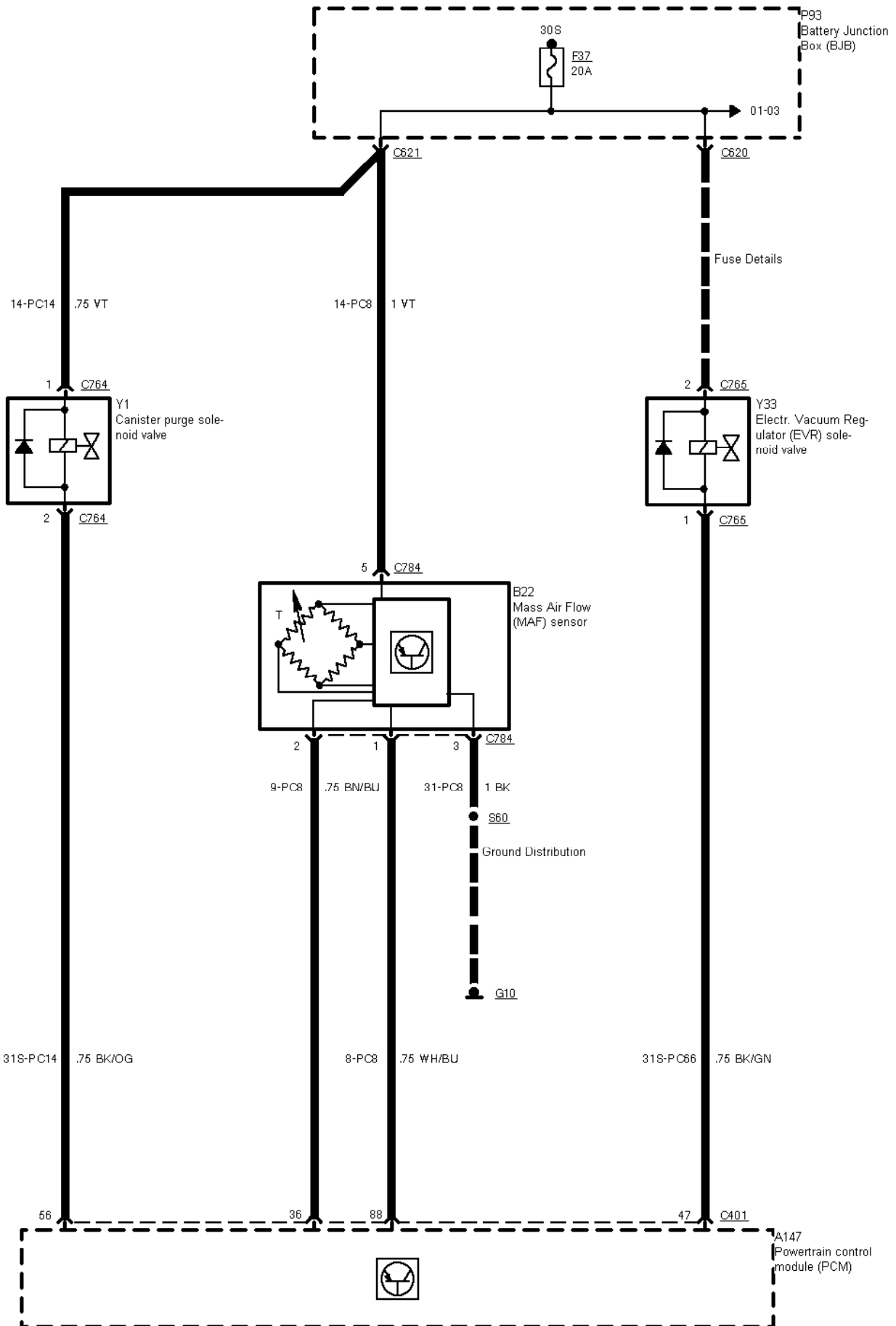

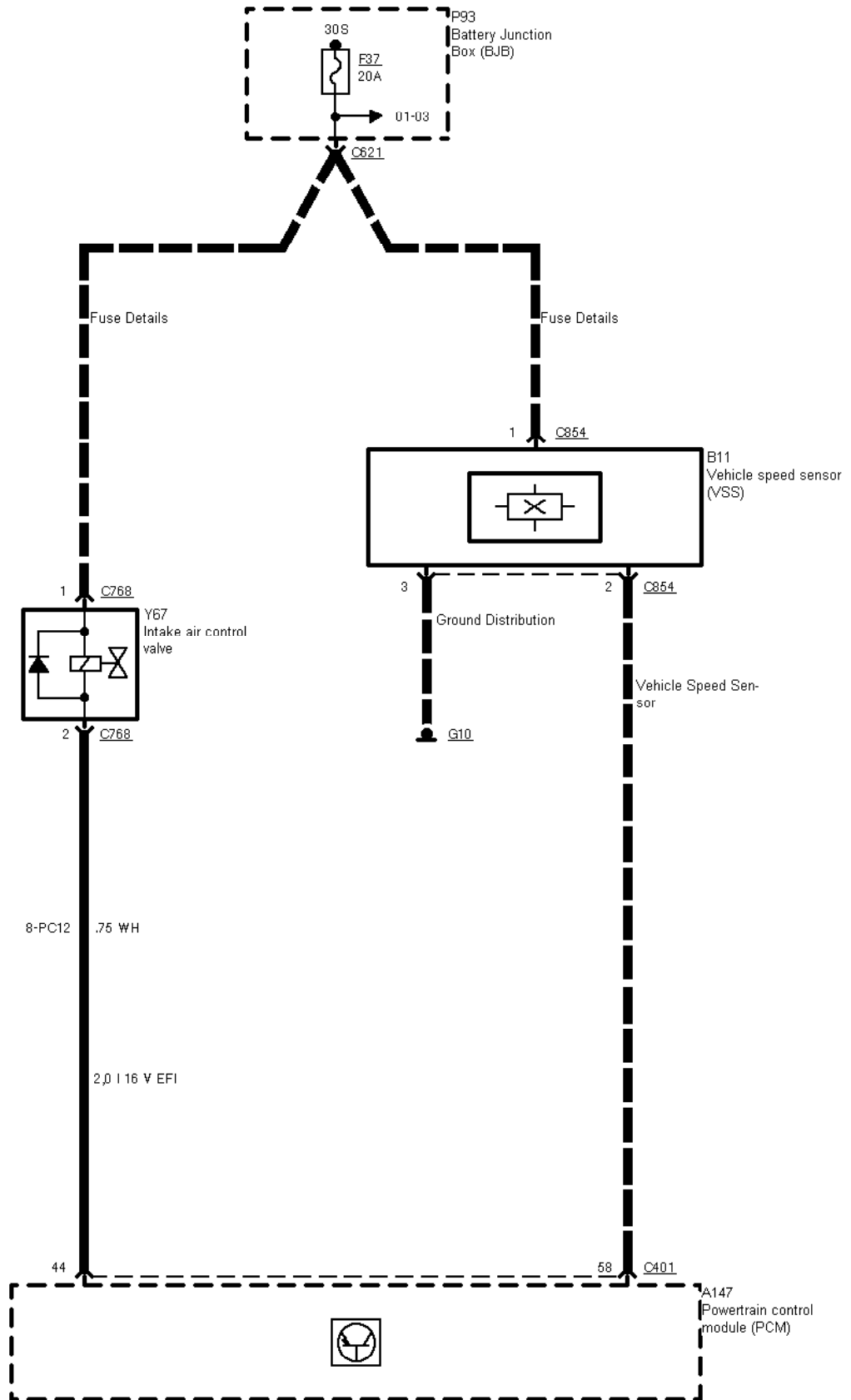

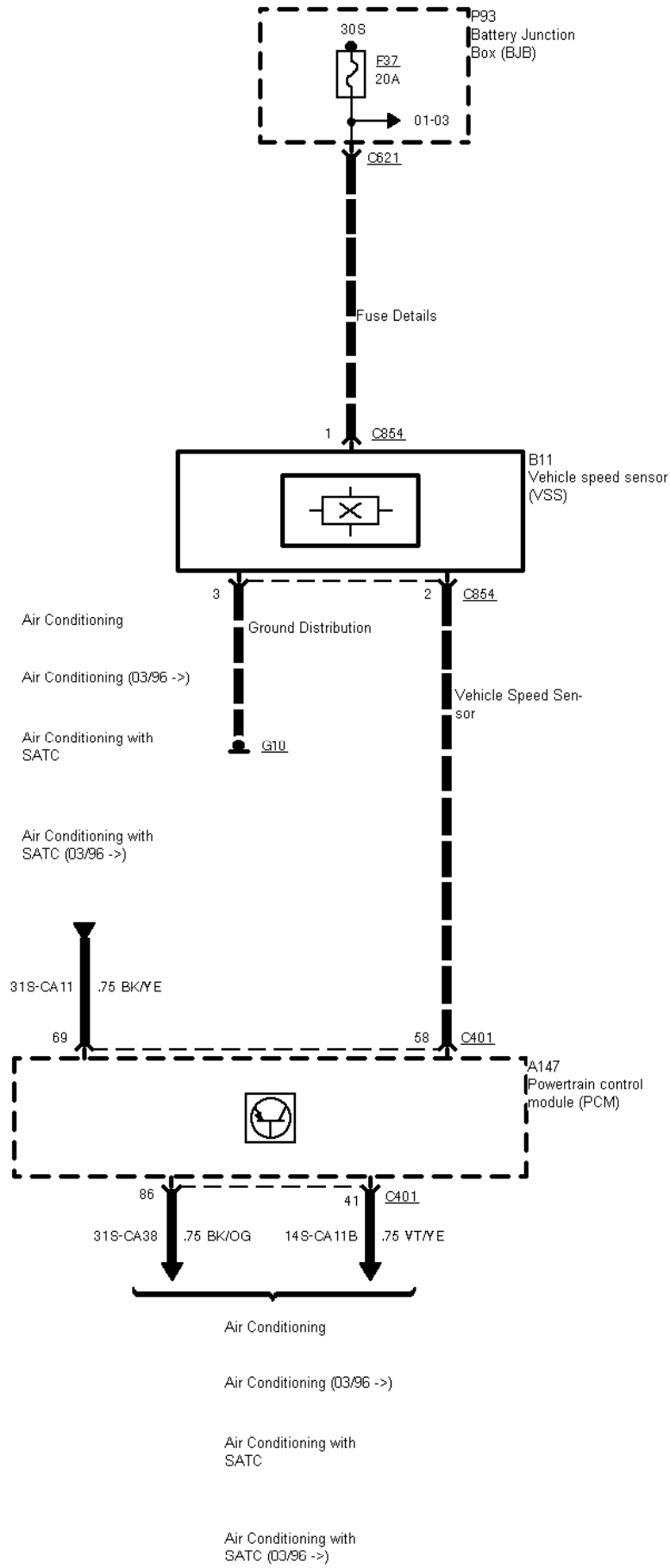

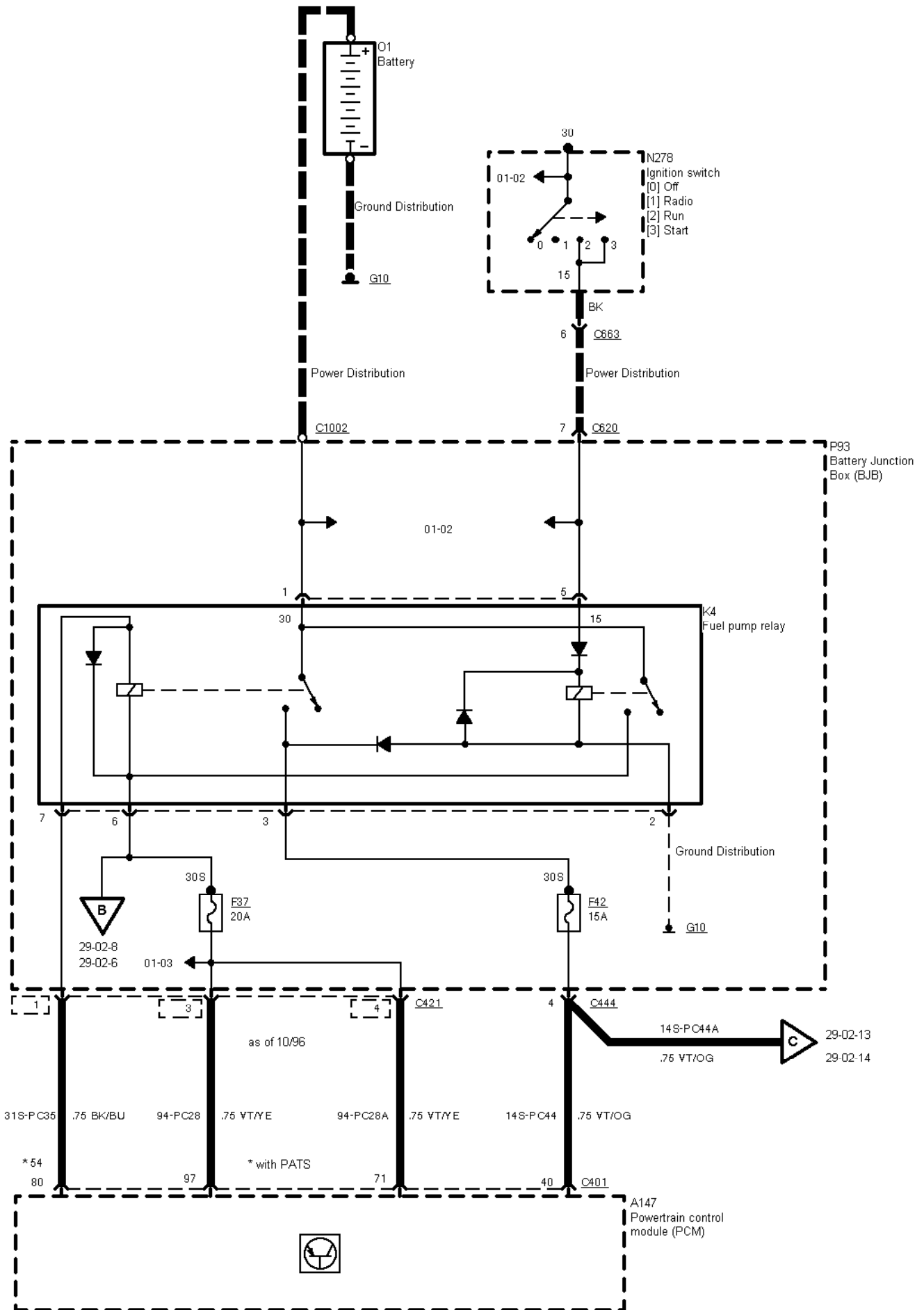

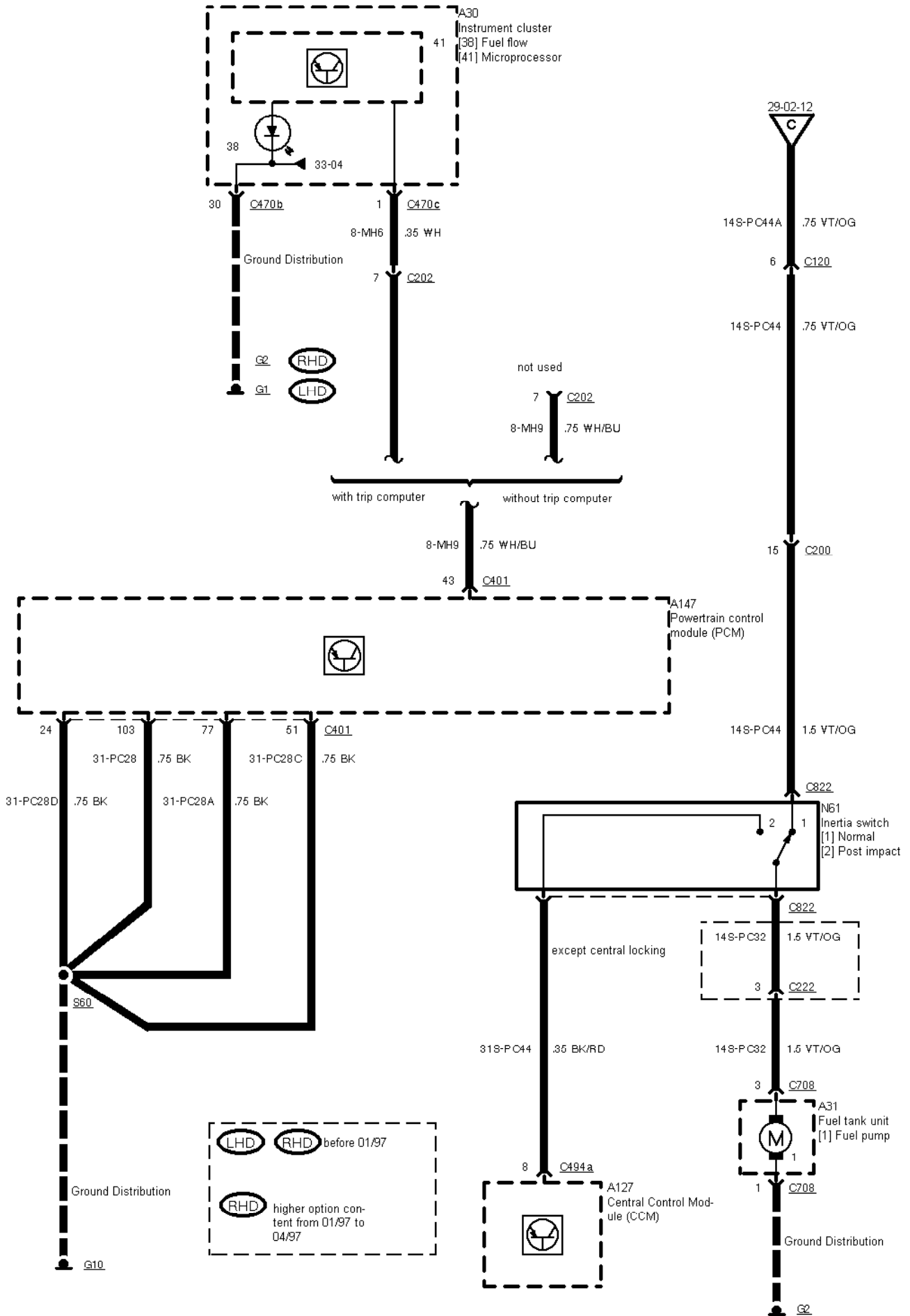

29-02-015 , Engine Control 2,0 I 8V/16V EFI (Manual Transmission) , Engine cooling fan

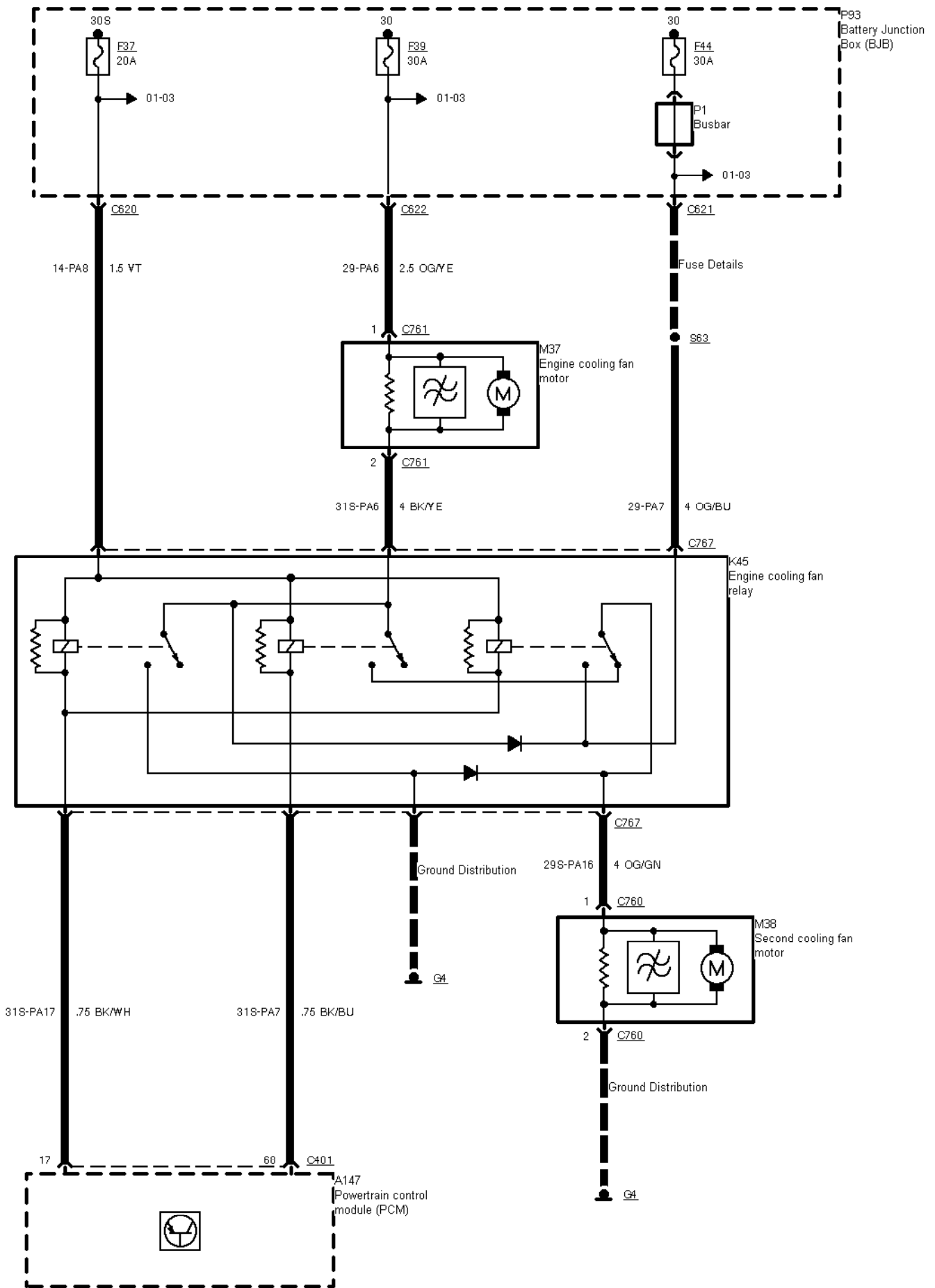

□ Circuit Description
